

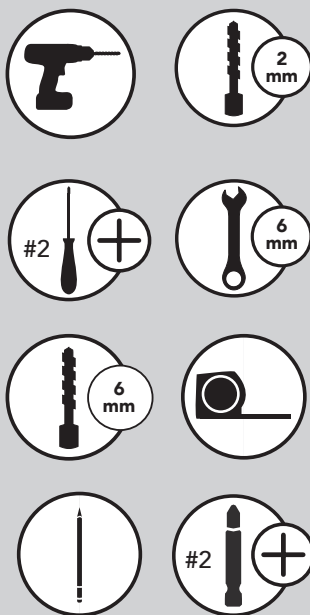

INSTALLATION INSTRUCTIONS

5PD PREMIERE PULL-DOWN SHELVING SYSTEM

TOOLS REQUIRED:



ESTIMATED ASSEMBLY TIME:

45 MIN

CARE AND MAINTENANCE:

Clean with a damp cloth and wipe parts dry. Keep all chemicals away from gas spring piston rod.



Parts List

No.	Description	Qty
A	Left Base Bracket	1
B	Right Base Bracket	1
C	Left Side Frame	1
D	Right Side Frame	1
E	Handle	1
F	5PD - 600 mm or 900 mm Baskets	2
G	Synchronizer Bar	1

Fittings

No.	Description	Qty
1	M32 x 6 mm Pan Head Screws	4
2	6 mm Cap Nuts	4
3	6 mm Washers	4
4	M5 x 12 mm Pan Head Screws	2
5	4G x 18 mm Flat Head Screws	16
6	M4 x 6 mm Pan Head Screws	12
7	M5 x 12 mm Flat Head Screws	4
8	Logo Covers	2
9	M4 x 4.5 mm Pan Head Screws	2

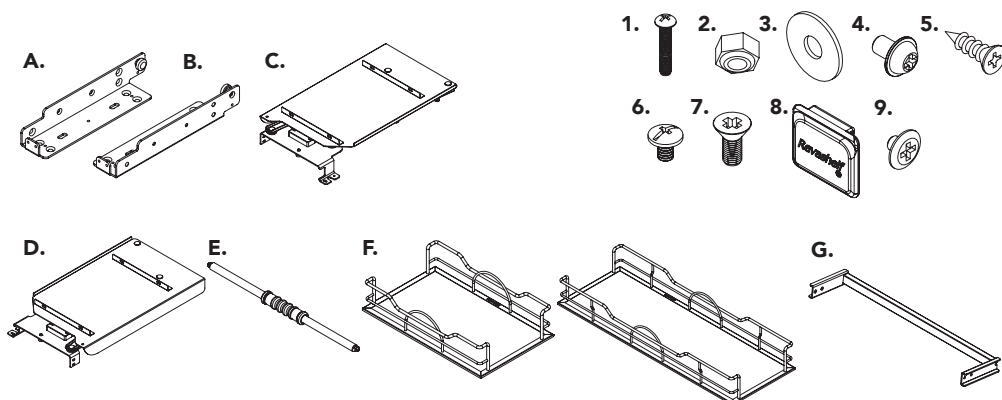

CHOOSING THE DESIRED BOTTOM SHELF

The shelves are reversible: choose between gray or white. To change the shelves, unscrew the (4) M4 x 4.5 mm pan head screws from the bottom of the shelf, flip them over, and screw back into place (See Figure A).

FIGURE A

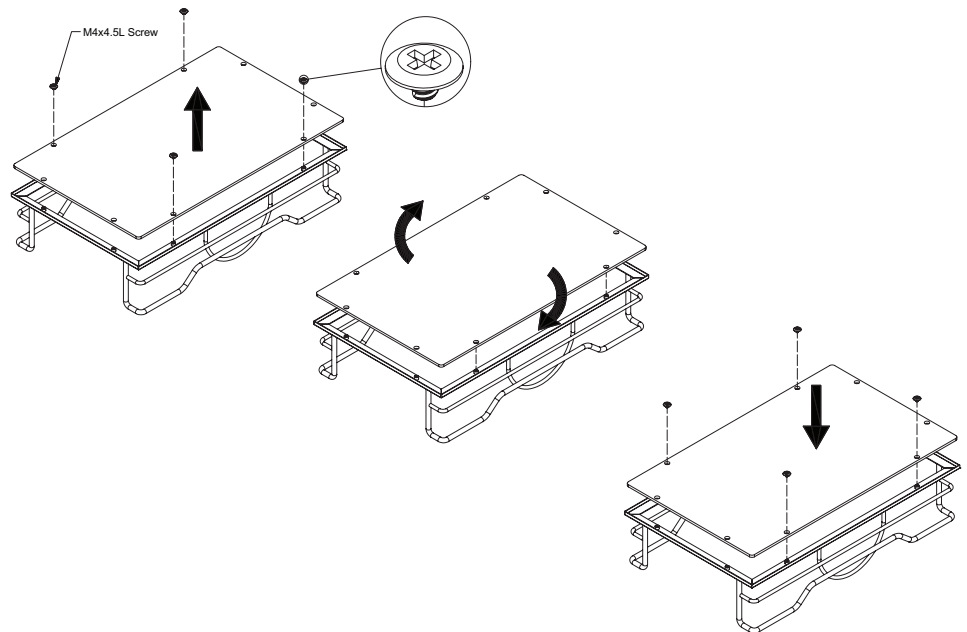

CABINET PREPARATION BOTTOM MOUNTING

Mark and drill pilot holes for the bottom mounting brackets to the cabinet floor (See Figures B and B-2).

Mount the base brackets to the cabinet floor using (8) 4G x 18 mm flat head screws. For heavy applications, it is recommended to add M32 x 6 mm pan head screws through the base brackets and cabinet floor (See Figure B3).

Note: 600 mm shelf - inside cabinet width must be between 564-568 mm.

900 mm shelf - inside cabinet width must be between 864-868 mm.

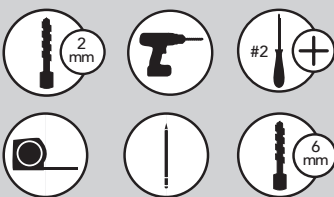

FIGURE B

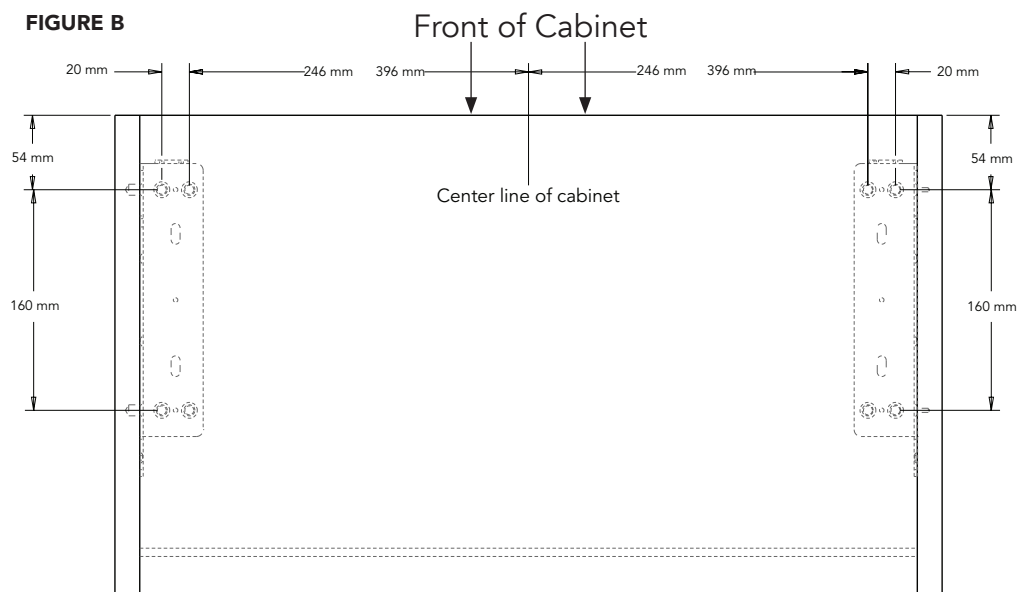

FIGURE B-2

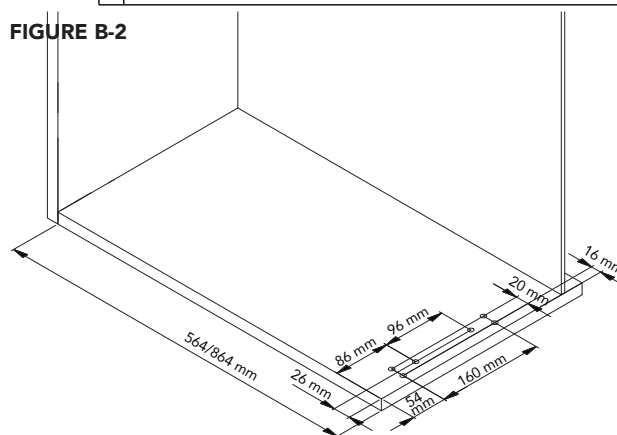
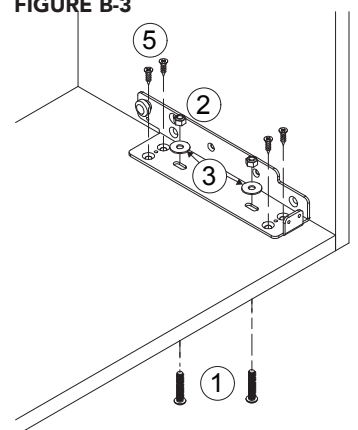

FIGURE B-3



CABINET PREPARATION SIDE MOUNTING

Mark and drill pilot holes for side mounting (See **Figure C-1**).

Mount the base brackets to the side of the cabinet using (10) 4G x 18 mm flat head screws (See **Figure C-2**).

600 mm unit - cabinet opening must be between 564-568 mm.

900 mm unit - cabinet opening must be between 864-868 mm.



STEP 1

Attach the two wire baskets to the side frames using (8) M4 x 6 mm pan head screws (See **Figure D**).

Note: Screws may already be attached to the brackets.



STEP 2

Attach the handle to the side frames using (2) M5 x 12 mm pan head screws (See **Figure E**).

Note: Screws may already be attached to handle.

FIGURE C-1

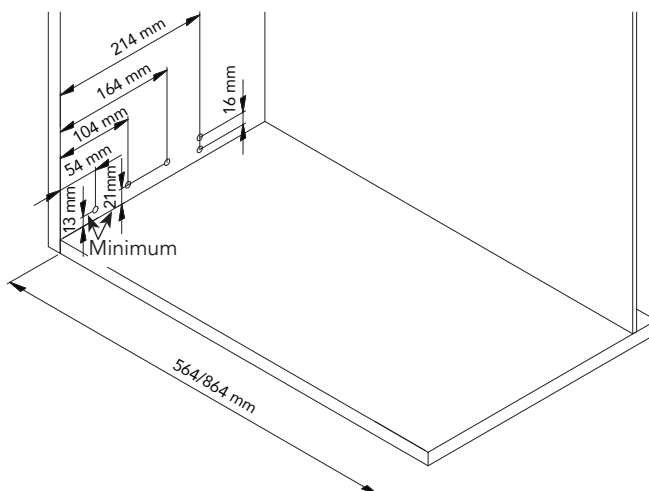
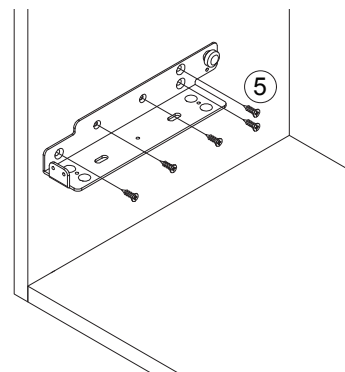

FIGURE C-2



Assembly

FIGURE D

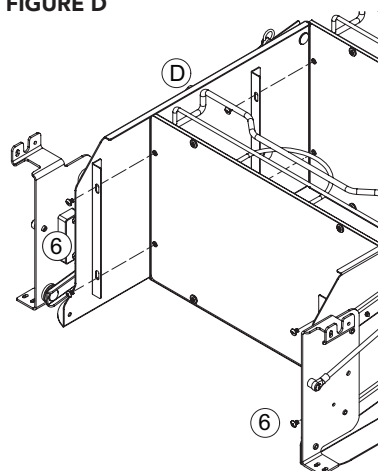
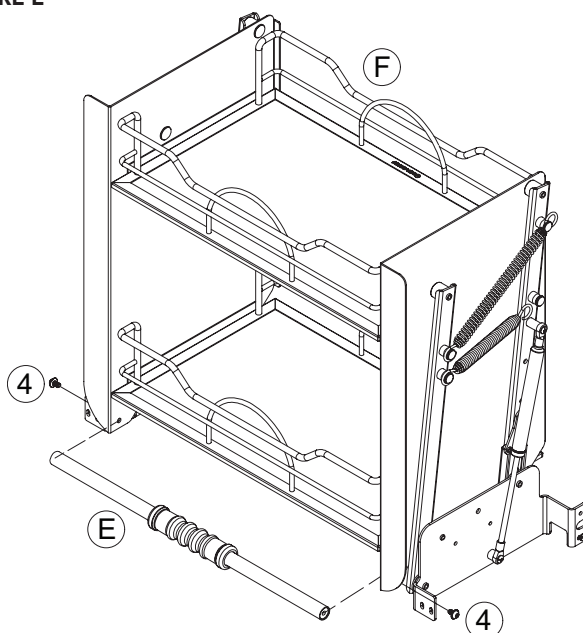

FIGURE E



STEP 3

Mount the assembly by sliding the side frame brackets over the base brackets and secure in place using (4) M4 x 6 mm pan head screws (See Figure F).

Note: The rear of the side frame brackets will slide over a pin on the base brackets.



FIGURE F

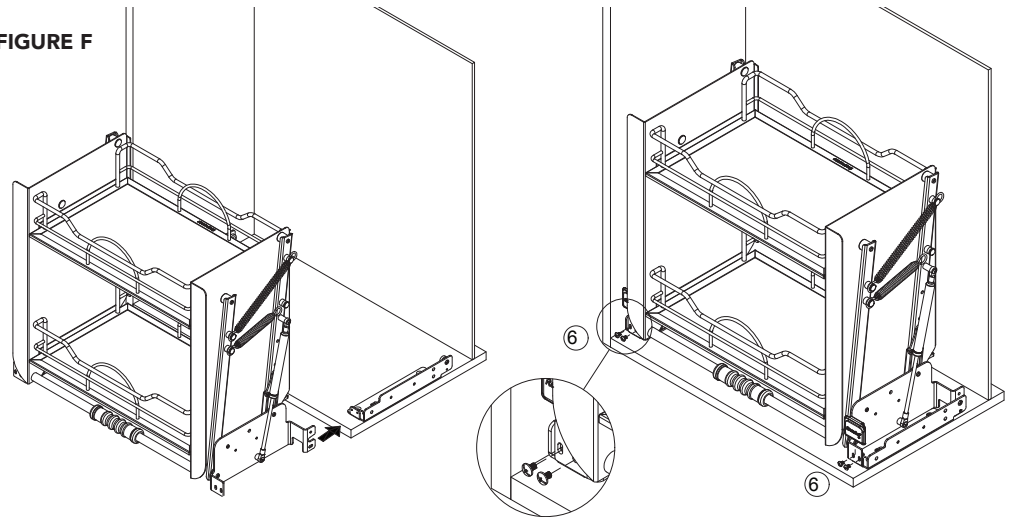

STEP 4

Attach the two cover plates to the side frames to cover the screws installed in Step 3.

Attach the synchronizer bar to the rear frame arms by tilting the bar at an angle and sliding it down the main body from front to back. Secure the bar in place by using (4) M5 x 12 mm flat head screws (See Figure G).



FIGURE G

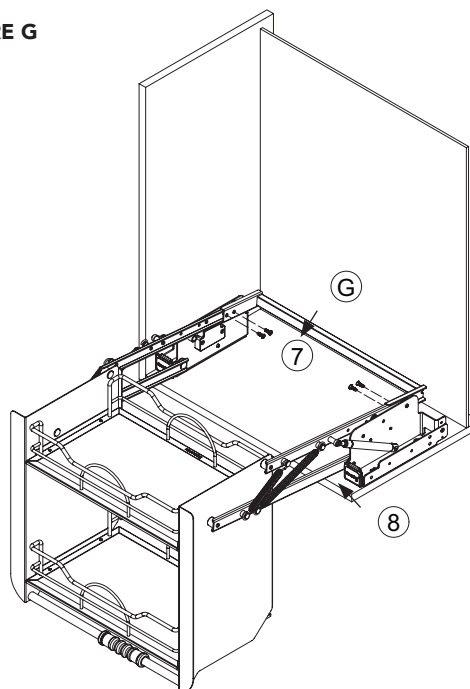

OPERATION

OPEN

Grab the handle and pull straight out.

As the shelf system comes out of the cabinet, continue to pull out and down until the shelf is locked in the down position.

CLOSE

Grab the handle and pull down to release the lock.

The unit should return inside the cabinet on its own power.

If it is heavily loaded, you may need to assist with the return by lifting the handle.